

# FLAG TRONICS

**Trans Am**

PRESENTED BY







Buy your "Trans Am FT200 In-Car Kit" today  
at <https://www.flagtronics.com/TransAm>



## FT200 Wireless Flagging Display Mounting Tips:

A Flagtronics FT200 is required for all 2023 Trans Am National Championship Events. You can order yours now at <https://www.flagtronics.com/TransAm>.

- For maximum performance, we recommend the FT200 be connected to 12V power via flying leads or a USB adapter (Type A plug) capable of 10W (5V 2A) or more that is connected to the vehicles main power feed. Be careful using auxiliary power switches as drivers may forget to power on at start-up. Note: *Lower power chargers will result in lower screen brightness or improper function.*
- If connected properly, the FT200 will automatically power ON when vehicle's main power is switched on and will turn itself OFF 15 minutes after vehicle's main power has been switched off. To manually power ON the FT200, press the top button on the front of the unit. To manually power off, hold the top button until the screen displays "OFF" then release.
- The FT200 Serial # is printed on the bottom of the unit. Please write down this 8 digit number for your records. Your race series needs this S/N in combination with your Car # for Race Control correlations.
- The FT200 unit must be mounted horizontally within the driver's direct view or immediate periphery. See detailed dimensions and mounting recommendations below.

			
Powered by either USB or 12V leads	Flagtronics FT200 Wireless Flagging Display (left) and GPS antenna (right).		FT200 Harness

The FT200 is a safety device and must be highly visible to the driver. We recommend positioning the display above the gauge cluster or center panel in a way that remains in the driver's direct view or immediate periphery.

The GPS Antenna should be placed forward on the dash under the windshield, 6" away from any edges and 6" away from other antennas and clear of any vertical bracing and/or windshield wipers. The GPS is directional and the rear, where the wire exits, should point to the rear of the car.

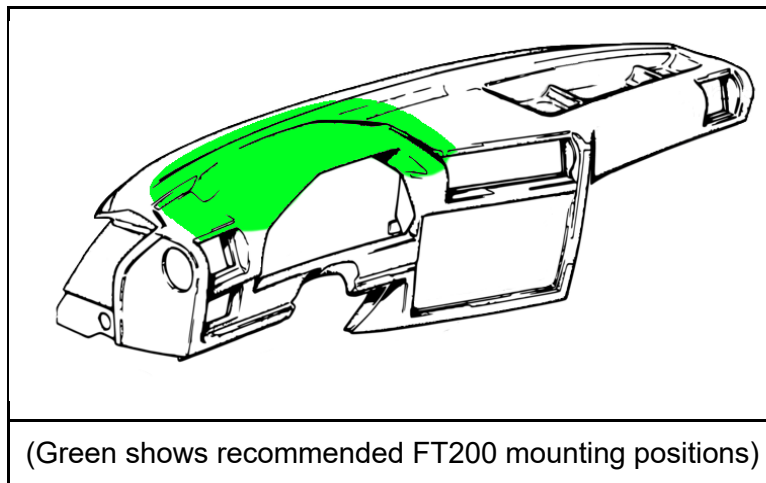

A light sensor at the rear of the unit and another one on the front of the unit adjusts brightness to ensure the display is dim at night and bright during the day. Please keep this light sensor, shown in the image to the right, unobstructed for best performance. The FT200 has 6 programmable light curves available for those who wish to tune this to their need using the buttons on the front of the unit. Settings 1-3 use the light sensor to automatically adjust brightness and settings 4-6 are static brightness levels. Setting 3 is most popular.

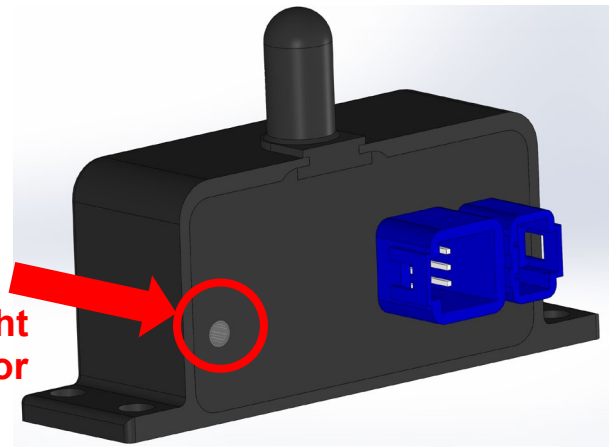

**Light Sensor**

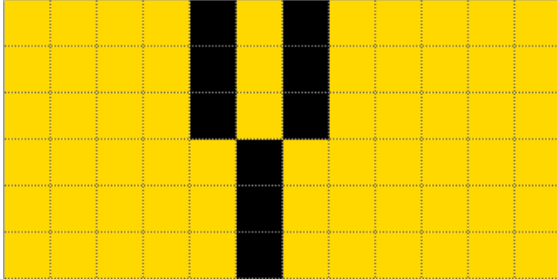

Here is a grid display example of the full course yellow condition that the FT200 unit will display. For more information and display states, please click [here](#) to download the full FT200 Product Manual.

Flagtronics FT200 dimensions (mm) for mounting.

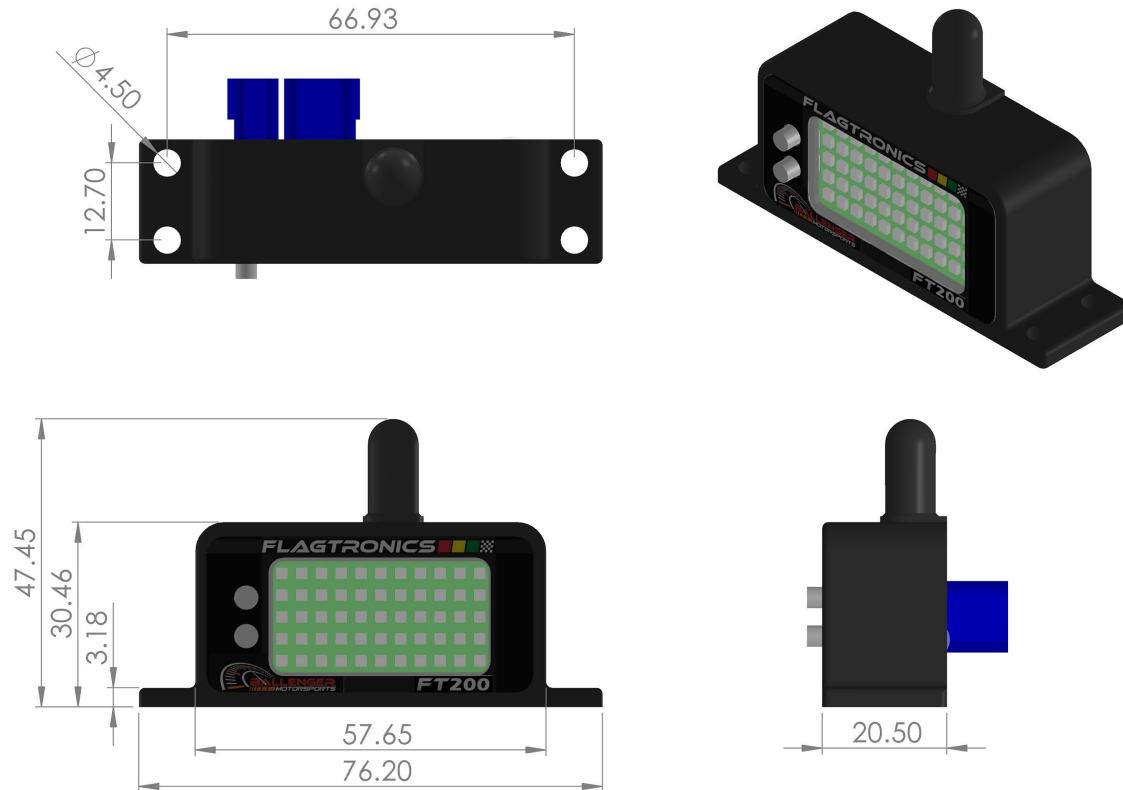

The FT200 may be direct screw mounted, zip tie mounted, or mounted with one of our mounting kits. Kits and Accessories may be purchased online by visiting <https://www.flagtronics.com/TransAm>.

FT-03646 (1/4-20 Mount)	FT-03648 Cage Mount Kit	FT-20003 Battery Only
FT-03647 (GoPro Mount)	FT-03650 Suction Cup Mount Kit	FT-20063 Harness Only